

# Plinth | Medical



## Model 502CT Changing Table

Models: 502CTE & 502CTH

# USER MANUAL

---

## **Contents**

<b>1. Introduction</b>	<b>3</b>
General Warnings	3
<b>2. Installation</b>	<b>4</b>
Adjustable Foot	4
Power Supply	5
Lifting and Moving	5
<b>3. General Operation</b>	<b>6</b>
Electric Operation	6
Retractable Castor Operation	7
<b>4. Accessories Operation</b>	<b>8</b>
Fold Down Cot Sides	8
Foot Switch (multi motor)	8
<b>5. Cleaning and Decontamination</b>	<b>9</b>
<b>6. Troubleshooting</b>	<b>10</b>
<b>7. Maintenance</b>	<b>11</b>
<b>8. Guarantee and Service</b>	<b>12</b>
<b>9. Technical Specification</b>	<b>13</b>
<b>10. Revisions to Manual</b>	<b>14</b>

Plinth Medical Ltd is an ISO Audited company to ISO9001:2008



Our products are CE marked in conformity with the EC Directive MDD 93/42/EEC

## 1. Introduction

Thank you for purchasing a product from Plinth Medical Ltd. We use the highest quality components and manufacturing techniques to ensure that our products are simple to use and will last a long time. It is recommended that all users read and retain this User Manual for reference.

Throughout this manual notice is made of a Warning and Caution system to highlight to the user practices, procedures or conditions that should either not be allowed to happen or happen with caution.

**Warnings are in a box with bold type and identify potential hazards, procedures or conditions which could result in death, injury or serious damage.**

Cautions are in a box with plain type and identify conditions or procedures where if caution is not taken it may result in damage or failure of equipment.

### General Warnings

#### **WARNING**

**Maximum Load (SWL) is 250kg distributed evenly.**

**Do not use flammable gasses in proximity to an electrically operated changing table.**

**Do not concentrate weight on either side or either end of the changing table.**

**Use only accessories approved for use with this changing table.**

**Disconnect power supply before moving changing table.**

**Children must be adequately supervised in the presence of the changing table.**

**Do not allow children to play with the changing table at anytime.**

## 2. Installation

Although this changing table comes complete and is virtually ready to use it is important to remove all packaging and read the following before use.

### **Retractable Castors**

The castors can be operated from either side of either end of the changing table. Press the pedal down to engage the castors and lift the pedal to retract the castors.

Please refer to the Operation section on page 7 for further details.

### **WARNING**

**Castors must be retracted before the changing table is used and whilst patients get on or off the changing table.**

**Care should be taken to ensure patients do not trip over any part of the changing table when getting off.**

### **Adjustable Foot**

Fitted to the head end of the changing table is an adjustable foot. This is designed to stabilise the changing table and must be set before use. The foot should be wound in/out until it is firmly in contact with the floor whilst the castors are retracted. Check that the changing table is firm and stable and then adjust the lock nut back up against the changing table leg to lock the adjustable foot in position. Incorrect adjustment will result in the changing table being unstable and the wheel pedals difficult to operate.

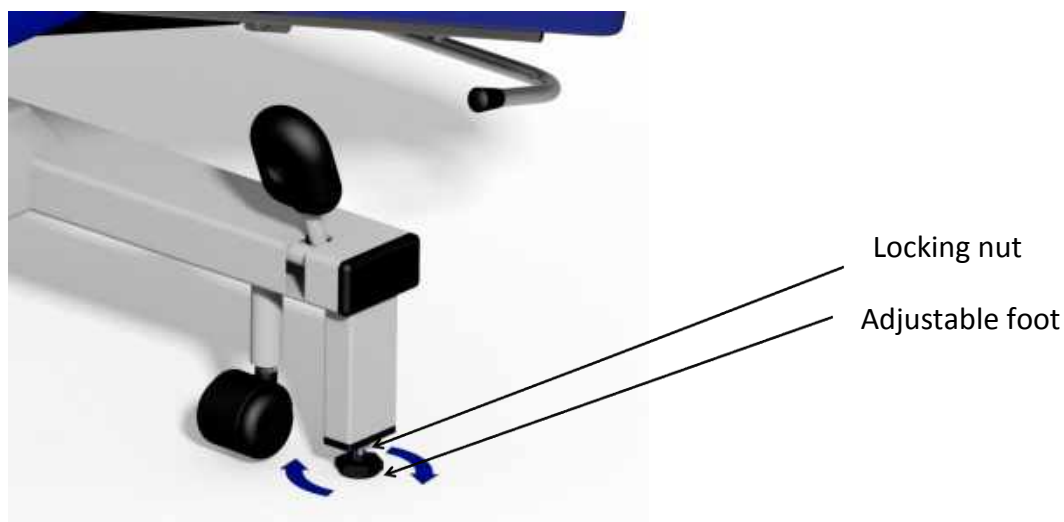

### **Power Supply (electric version only)**

Ensure that hand or foot switch leads are clear of the moving parts of the changing table before operation. Connect the changing table to a normal domestic type power supply observing the following notes.

#### **WARNING**

**Ensure that the mains lead, plug and socket are in good condition before connecting the equipment.**

**Ensure that the mains cable has a clear run and is not stretched when connected and that no one can fall over the cable.**

#### **CAUTION**

When changing table is not in use switch off power supply.

### **Lifting and Moving**

Should the changing table need to be moved or lifted (for example to remove it from its packaging) then a minimum of two people are required. The changing table must only be lifted by the metal base frame near the wheels. If the changing table is upside down then it may be carried by holding it underneath the upholstery. When turning the changing table over, please make sure the frame and upholstery are supported at all times, otherwise damage may occur to the upholstery.

#### **CAUTION**

Under no circumstances lift the changing table by the upholstery or top sections as damage will occur to the gas spring mechanisms.

### 3. Operation

Plinth Medical offers 2 models of 502CT in 3 standard lengths (1200mm, 1500mm and 1800mm); 502CTE being the electric version and 502CTH being the hydraulic version.

#### Electrical Operation General

##### **WARNING**

**Safely position patient before operating any functions.**

**Position the switch in a place where it is clear of the moving parts of the changing table and where accidental operation is not possible.**

**Ensure that all electrical cables are clear of the moving parts of the changing table.**

#### Electrical Operation (hand single motor)

For model 502CTE electric changing tables the standard hand switch fitment is a pneumatically operated rocker switch as shown below.

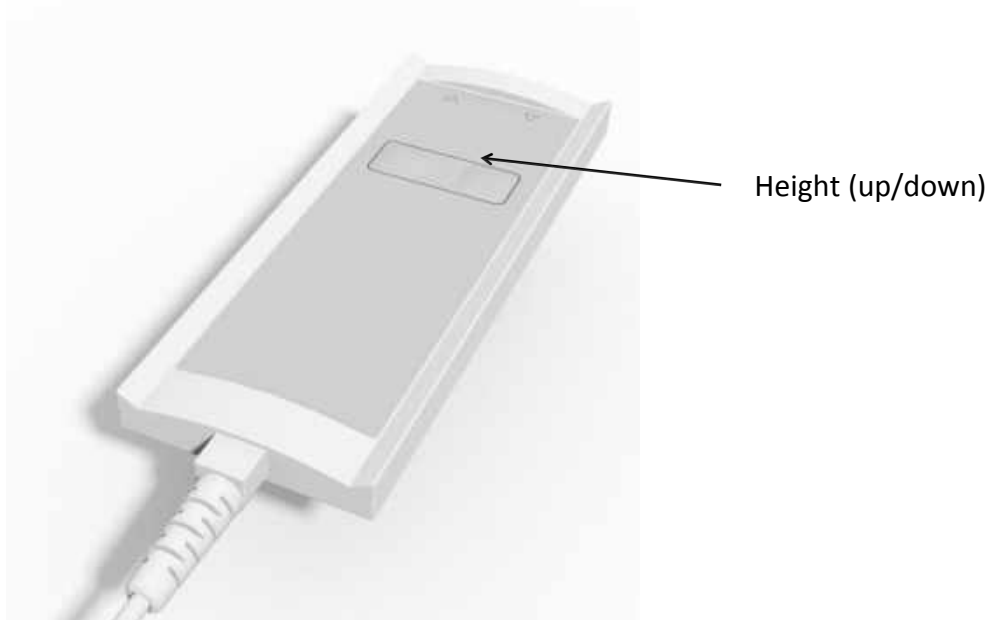

#### Electrical Operation (foot)

As an option this changing table may be supplied with a foot switch to operate the electrical functions. It will operate in the same way as the hand switch but must be placed on the floor and operated by foot. For further information see page 8.

## **Retractable Castor Operation**

The castors fitted to this changing table are 50mm retractable castors. They are operated individually at each corner of the changing table via the wheel pedals.

**NOTE – the castors are not designed for patient transport.**

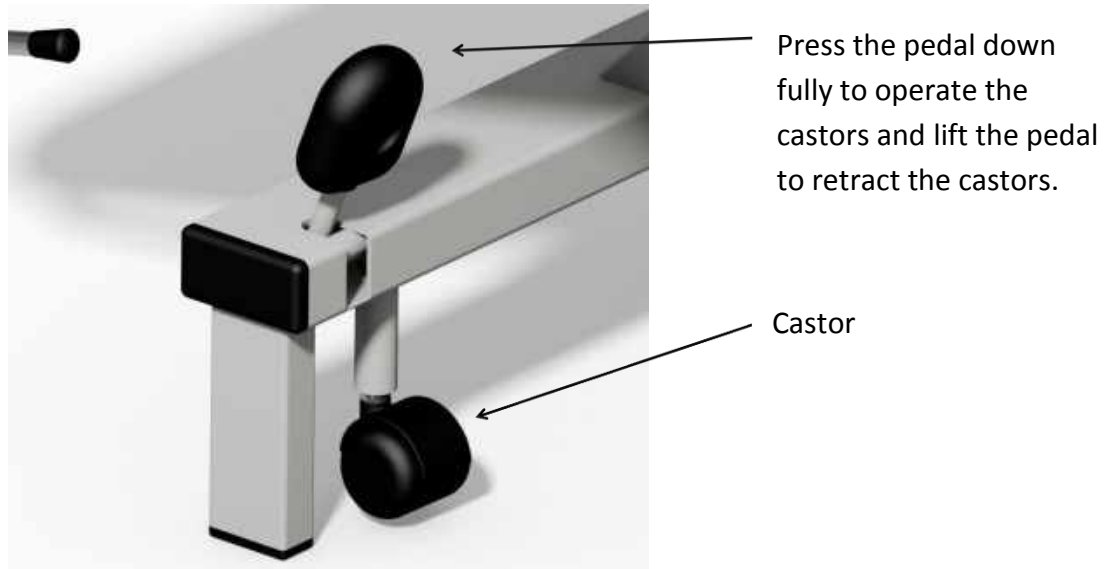

### **WARNING**

**Castors must be locked before the changing table is used and whilst patients get on or off.**

**Disconnect and coil electrical leads and switch away from the changing table mechanism prior to moving the changing table.**

## 4. Accessories Operation

### Fold Down Cot Sides

Standard fitment fold down cot sides are operated as follows:

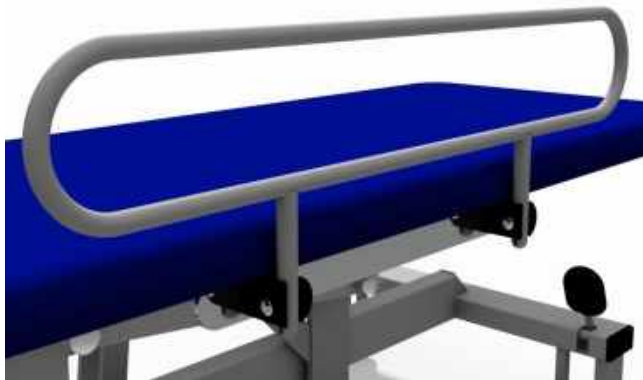

**To raise the cot side** from the down position; lift and rotate the cot side towards you through a full 180°. When upright push the cot side down into the plastic block until it is fully located.

**To lower the cot side** from the upright position; lift up in the plastic block and then rotate a full 180° into the down position.

### **WARNING**

**Ensure that the cot side is fully engaged in the plastic block whilst in use.**

### Foot Switch Operation (single motor)

An optional fitment foot switch may be specified for the changing table and the switch fitted will look similar to the one pictured below.



← Height (up/down)



## 5. Cleaning and Decontamination

### WARNING

If contamination is suspected then decontaminate the changing table before use.

Torn or damaged upholstery should be replaced immediately.

### CAUTION

Do not use Alkalis or other organic solvents for routine cleaning.

Always cover the vinyl with paper towelling or changing table covers if it can come into contact with bare skin.

### Cleaning

Always wear suitable protective clothing before carrying out this procedure.

Disconnect the mains supply to the changing table and move it to a suitable cleaning area and lock the castors.

**Step 1.** Using warm water and soap on a damp cloth, carefully wipe the changing table over from top to bottom. Take great care around electrical components.

**Step 2.** Wipe the changing table carefully from top to bottom using a clean damp cloth and soap free water.

**Step 3.** Carefully dry the changing table from top to bottom with clean lint free paper towels.

### Decontamination

To decontaminate the changing table repeat the above steps but using a dilute solution of Hypochlorite and warm water (10,000ppm) instead of warm water and soap. At the end of the procedure discard all cleaning materials in a safe manner and wash hands thoroughly.

## 6. Troubleshooting

In the unlikely event of the changing table failing to operate and having carried out the normal practical fault finding steps below then please contact our Customer Service Team on +44 (0)1449 767887 or email [customerservice@plinthMedical.com](mailto:customerservice@plinthMedical.com). **Please have the serial number to hand before making contact so we can help you more efficiently.**

Fault	Possible Cause	Remedy
Changing table is unstable	Uneven floor Adjustable foot	Move changing table to flat floor  Check presence, condition and adjustment of foot
Motor will not work (502CTE only)	Power disconnected Fuse Blown Hand/ Footswitch disconnected Fault with switch Fault with motor	Connect power supply  Replace fuse in plug  Check the switch is fully connected to the motor  Replace switch  Replace motor
Motor sinks (502CTE only)	Switch permanently operated Motor fault	Unplug and re-connect switch  Replace motor
Hydraulic pump will not work (502CTH only)	Pump fault	Replace pump
Hydraulic pump sinks (502CTH only)	Valve stuck	With changing table at max height pump pedal for a further 20-25 strokes to clear valve

## 7. Maintenance

Plinth Medical Ltd products are designed to be maintenance free. However keeping your Plinth products clean and regularly checked will assist in prolonging their working life. The following is a guide of simple checks that the user can carry out on a six monthly basis. We would also recommend an annual service visit by a Plinth Medical trained engineer.

### **WARNING**

**Disconnect changing table from electrical supply before commencing any of the following checks.**

Examine the changing table for any signs of damage. Pay particular attention to all nuts, bolts and fasteners to check they are present and tight but not over tight.

Upholstery bolts should all be checked (each section has between 2 and 6 No. M6 bolts), they should all be present and tight.

Check gas struts (if fitted) and ensure that they operate through the full range of movement and lock fully.

Check hinge pins are lubricated.

Check main changing table nylon pivot bearings are lubricated sufficiently.

Examine mains and switch cables for any damage, cuts, kinks, abrasions etc. These must be replaced if necessary.

Check mains lead, switch cables and slave motor leads are all correctly and securely attached.

Check correct plug fuse is fitted (5A).

### **WARNING**

**Any electrical checks or work other than the visual inspection above must be performed by a qualified electrician.**

**Do not connect BLUE or BROWN wires to the earth terminal of a plug.**

## **8. Guarantee and Service (UK only)**

Plinth Medical Ltd offer a 5 year parts guarantee on all 500 Range products delivered from January 2013 and a lifetime frame guarantee. The only exclusion to this guarantee is for negligent damage or damage to upholstery coverings. This guarantee does not require registration of the product as we can trace it from its serial number, however in the event of the serial number being removed, missing or unreadable then this may void the guarantee. These terms do not affect your statutory rights.

**In addition to the above Plinth Medical Ltd can offer both extended warranties and service contracts. For further information about either of these please contact:**

Customer Service  
Plinth Medical  
Barric Lane  
Occold  
Eye  
Suffolk  
IP23 7PX  
Tel: 01449 767887  
Mail: [customerservice@plinthMedical.com](mailto:customerservice@plinthMedical.com)

In the event of returning a product or part to us then please follow the instructions for cleaning under section 5 before enclosing it in suitable packaging and returning it to the above address. In addition please ensure there is a statement confirming that it has been decontaminated and what the fault is along with relevant contact details.

### **Worldwide**

Please contact the distributor you purchased the changing table from for service and support in your country. If you are unable to do so then please contact us in the UK and we will refer you to our local representative.

## 9. Technical Specifications

	502CTH	502CTE
Length (cm)	1200/1500/1800	1200/1500/1800
Width (cm)	63	63
Height Range (cm)	47-98	47-98
Max Working Load	250kg	250kg
Control	Pedal	Hand switch
Hydraulic Pump	Roemheld	N/A
Motor(s)	N/A	Linak LA31 x 1
Control Box	N/A	Linak CB09
Current	N/A	1.5A
Power	N/A	360W
Mains Plug Fuse	N/A	5.0A x 1
Internal Fuse	N/A	1.5A x 1
System Voltage	N/A	24v
IP Rating	N/A	IPX4
Motor(s)	N/A	Linak LA31 x 1
Control Box	N/A	Linak CB09
Current	N/A	2.7A
Power	N/A	360W
Mains Plug Fuse	N/A	5.0A x 1
Internal Fuse	N/A	3.0A x 1
System Voltage	N/A	24v
IP Rating	N/A	IPX4

### IEC 601-1 Electrical Safety Classification

All electric models are double insulated Type B equipment and marked as such.



Double Insulated



Type B Equipment

## 10.Revisions to Manual

Pages	Issue No	Name	Date
All	Manual - 01	Niall Dyer	13.06.2017

**Plinth Medical**  
**Barric Lane**  
**Occold**  
**Eye**  
**Suffolk**  
**IP23 7PX**  
**ENGLAND**

Plinth Medical Ltd In association with Plinth 2000 are an ISO Audited company to  
ISO9001:2008



Our products are CE marked in conformity with the EC Directive MDD 93/42/EEC